

Product Name :Electronic Components / Nema Connectors / ENO-3122  
Product Code : ENO-3122



Approvals



Features

NEMA Receptacles are available in wide range of current & Voltage ratings  
Wide range of mounting styles and terminals to suit various design requirements  
Components available according to UL and NEMA standards  
Wide range of operating temperature - up to 125 Deg Centigrade  
All the safety approvals are available for any colour.

### BASIC DIMENSIONS

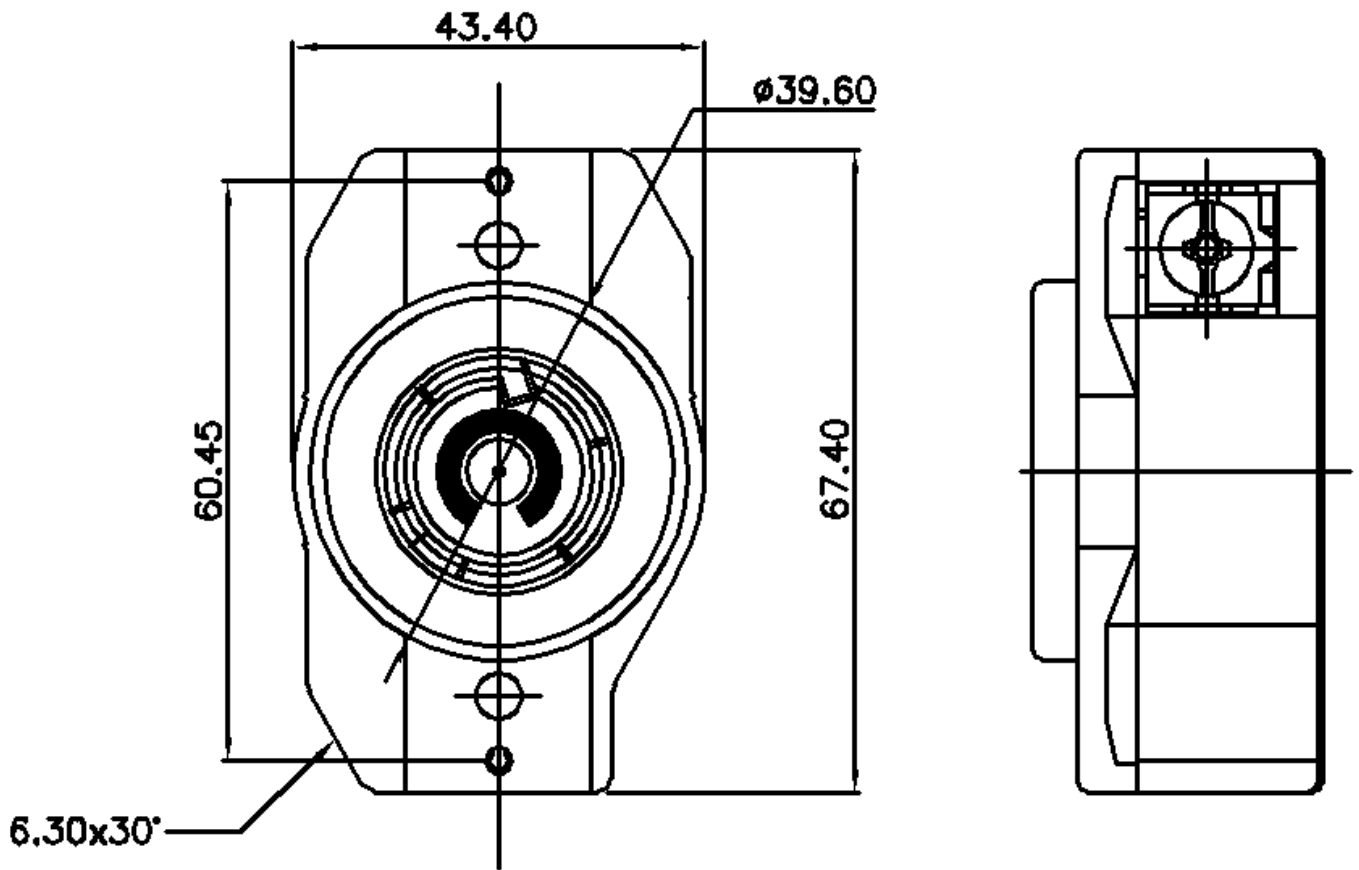



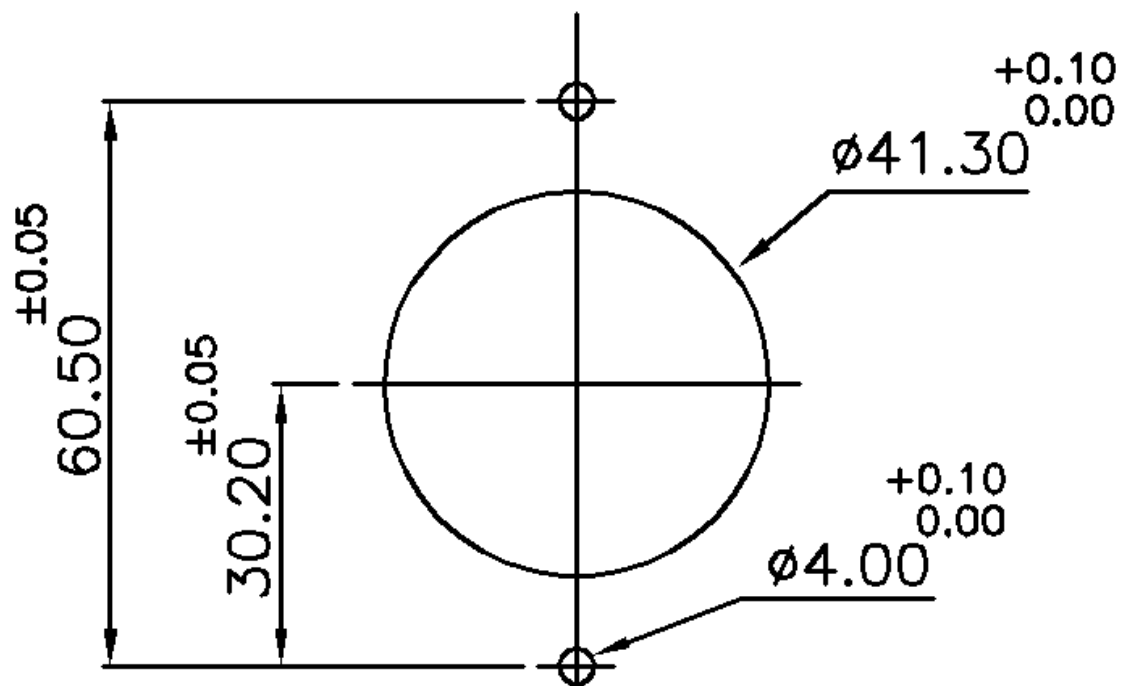



# PANEL CUTOUT





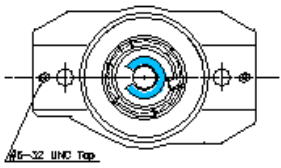



Specifications

Sr.No	Parameter		Specification
1	Product Category / Description		NEMA Receptacle
2	Type / Sub Type		Twist Lock
3	NEMA Type		L6-20R Type
4	Gender		Female
	Electrical Characteristics		
5	V/A Rating		250V 20A
6	Insulation Resistance at 500 VDC		100 M ohms Min.
7	H.V.Break Down Test (For 1-Minute)		2 KVAC
8	Contact Resistance (Initial)		10 m ohms Max
	Operating / Functional Characteristics		
9	Operating Temp. Range	With/Without Load	0 To 65°C
10	Flammability Rating		UL 94 V-2
11	Mounting Style		Screw - Type
12	Terminals (Standard)		Screw - Type # 14 To # 10 AWG
13	Tightening Torque		12 Kg-cm Minimum
	Material		
14	Body		Thermoplastic
15	RoHS compliant		Yes
16	Colour (Standard)	Colour	Black
17	Current Carrying Parts	(b) Contacts, Terminals	Cu Alloy
	Reference Standards / Safety Approvals		
18	Reference Standard		UL-498, UL-486E, NEMA WD 6:2002, CAN / CSA C22.2 No. 0-M91, CSA C22.2 No. 42-99
19	Safety Approvals		cULus, CSA

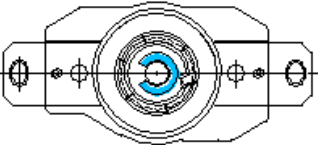
ANNEXURE A

Standard Variety				
Sr.no.	With Reference To	Available option	RoHS/Non RoHS	Safety Approvals & / Or Markings
1	Plastic Resin	Nylon 6 FR V-2		 
2	Mounting Thread Type			 

Other Customized Options Available On Request , Subject To MOQ & Commercial Acceptance.				
Sr.no.	With Reference To	Available options	RoHS/Non RoHS	Safety Approvals & / Or Markings
3	Body Colours	Any Colour in Nylon 6 FR V-2		 
4	Mounting (With Flange)			 
5	Mounting Thread Type	