

PRODUCT CODE:- **ERS-115**

CATEGORY:- **Rotary Switch**

BASIC DIMENSIONS:-

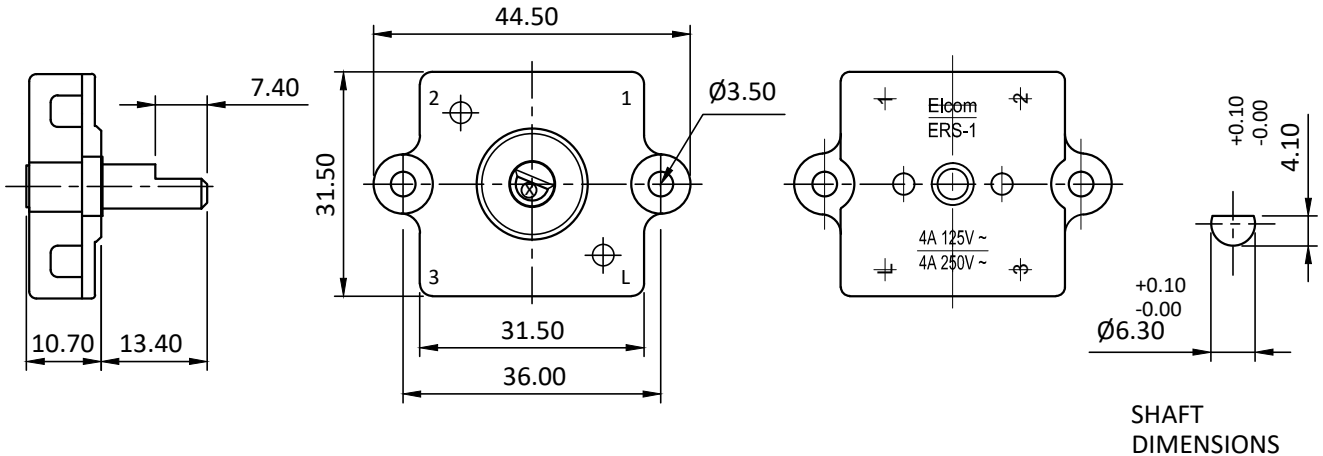

SHAFT DIMENSIONS

INTERNAL CONNECTION OF TERMINALS IN DIFFERENT POSITION

Type	45° 45° 45° 22.5°	45° 45° 45° 22.5°	45° 45° 45° 22.5°	45° 45° 45° 22.5°	Name of Switch	Shaft Colour (Code)
ERS-115	NILL (OFF)	L → 1	L ↘ 2	L ↙ 3	FUNCTION SWITCH	WHITE

TABLE FOR IDENTIFICATION OF SERIES

Engraving 'X' on Rotar	Switch indicates
X=5	ERS-115 Series

SPECIFICATION TABLE:-

Sr. No.	Parameter	Specification	
1	Type And Function	Rotary Switch	
2	V/A Rating	4A, 250VAC / 125VAC	
3	Contact Resistance(Initial)	20 m Ohms Max.	
4	Insulation Resistance at 500 V DC	1000 M Ohms Min.	
5	H.V.Break Down Test(For 1-Minute)	1 KV AC.	
6	Mounting	Chassis With Screw	
7	Terminals	Push-in type, 0.80 thick Min.	
8	Electrical Life	10,000 Cycles/Pole.	
9	Permissible Temp.	(a)With/Without Load	-25°C TO +85°C
		(b)For Soldering	270°C, 5 Sec Max.
10	Material	(a)Body	Nylon-GF.
		(b)Shaft	Nylon-GF;White
		(c)Current Carrying Parts	Brass/ Phosphor Bronze Nickel Plated
11	Reference Standard	IEC-1058-1(1996)	

APP	01.02.18	GJG	<p>Plot E-4, Kagal Five Star MIDC, Kagal, Kolhapur, MH - 416236, India Elcom International Pvt. Ltd. www.elcom-in.com</p>						
CHK	01.02.18	DPP							
DRN	01.02.18	Vicky							
REV	IS	WAS	DATE	SIGN	APP.	BY	DATE	SIGN	
UNSP.TOLERANCE		DIMNS. IN	WT(Gm)	SCALE:-	PROJECTION	SHEET	DRAWING NUMBER		
OVER	- 1 10	mm	Max.	NTS.		1 OF 1	P E R S 2 0 0 1	REVISION	
UP TO	± 0.2 0.3 0.5	Moulding, plating details as per Bill of Material Unspecified colour is Black, GF:Glass filled.		0					

F:ENG-08.00

Note: Technical specifications are subject to change without prior notice

Copyright © 2019 by Elcom International Pvt.Ltd, India. All rights reserved